



Formerly P.C. Simonton & Associates, Inc.

## Addendum No. Two

Date: December 1, 2020

Project: Pembroke 2020 Road and Water Improvements, MES No. 2020-35

Engineer: M.E. Sack Engineering  
Hinesville, Georgia

The original plans, specifications, and bid documents are amended to include the following:

Plans:

- Replace the previous sheets C300 and C500 with the attached sheets of the same.
  - Sheet C300 – additional spot shots were added along Ash Branch Road and Harry Hagan Road in order to clearly show existing grade along edge of pavement.
  - Sheet C500 – typical sidewalk detail updated to reflect sloping away from road and include grass between edge of pavement and sidewalk.

-END-



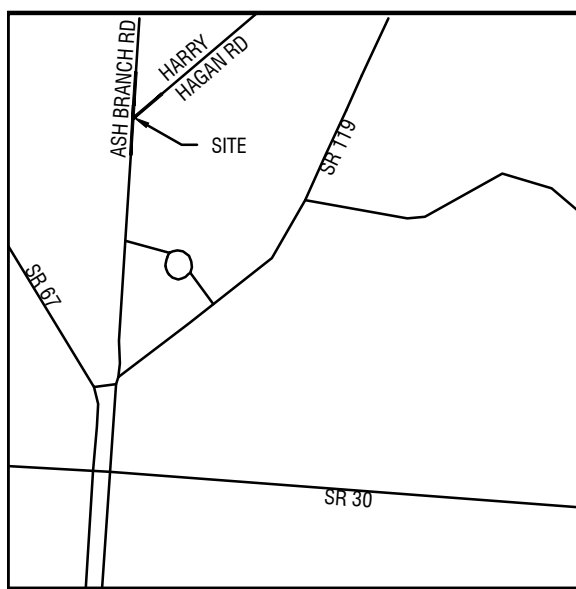

VICINITY MAP  
Not To Scale

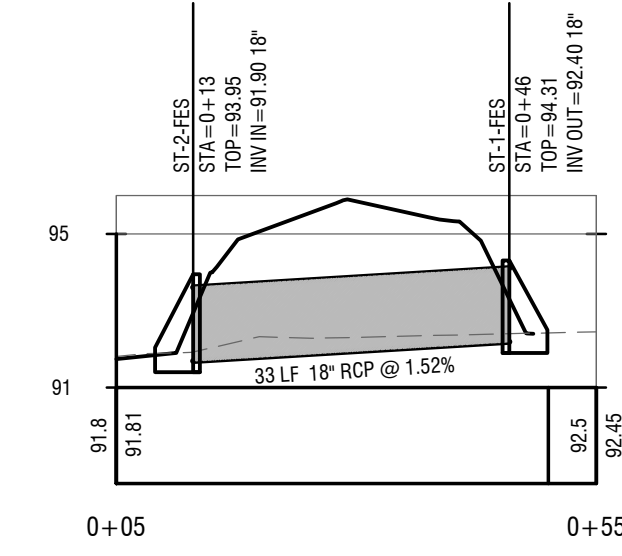
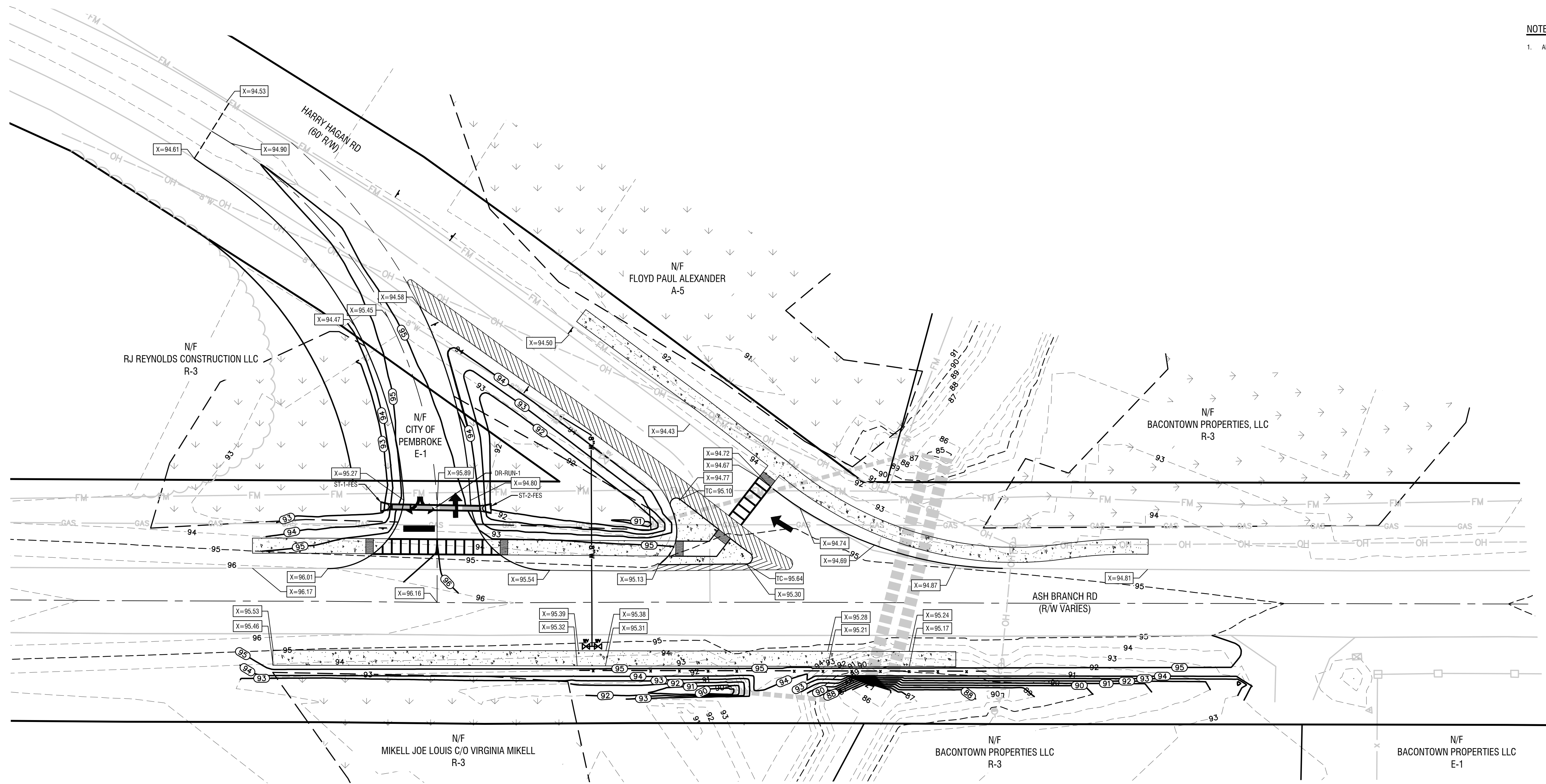

DR-RUN-1 PROFILE  
VERT. SCALE: 1"=5'  
HORIZ SCALE: 1"=20'

NOTES:  
1. ALL ROADS ARE GDOT CODE 2-PUBLIC ROADS.

REVISIONS:
1. ADDENDUM TWO 12/01/20

THIS DRAWING IS AN INSTRUMENT OF SERVICE AND REMAINS THE PROPERTY OF P.C. SIMOLTON & ASSOCIATES, INC. AND M.E. SACK ENGINEERING. IT MAY NOT BE COPIED, ALTERED, OR REPRODUCED IN ANY MANNER WITHOUT PERMISSION ON A SIGNED AND SEALED DOCUMENT. THE INFORMATION CONTAINED HEREIN IS INTENDED FOR THE NAMED CLIENT ONLY. IN THE EVENT OF AN ELECTRONIC VERSION P.C. SIMOLTON & ASSOC., INC. AND M.E. SACK ENGINEERING ASSUMES NO RESPONSIBILITY FOR DATA GENERATED, ALTERED OR STATED FROM THIS DRAWING. IN THE EVENT OF A DISPUTE, HARD COPIES WILL TAKE PRECEDENCE OVER ANY ELECTRONIC MEDIA.

DESIGN PROFESSIONAL:  
MARCUS E. SACK

515 NORTH MAIN STREET  
P.O. BOX 649  
HINESVILLE, GA 31313  
TEL: (912) 368-5212

135 GOSHEN ROAD  
SUITE 250  
RINGON, GA 31326  
TEL: (912) 295-2395

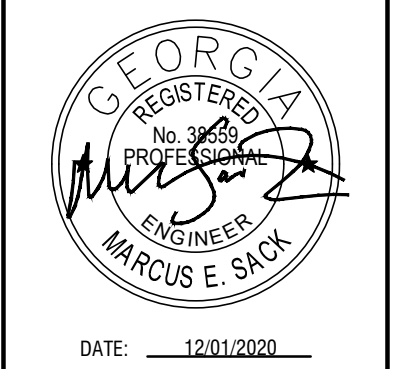

MUNICIPALITY:  
CITY OF PEMBROKE

COUNTY:  
BRYAN COUNTY

Owner:  
CITY OF PEMBROKE  
160 N MAIN ST  
PEMBROKE, GA 31321  
(912) 653-4413  
STREETS@PEMBROKEGA.NET

24 HOUR CONTACT:  
CITY OF PEMBROKE  
160 N MAIN ST  
PEMBROKE, GA 31321  
(912) 653-4413  
STREETS@PEMBROKEGA.NET

Pembroke City  
Street Improvements

HARRY HAGAN  
GRADING  
PLAN

C300

FILE NO: 2020-35  
PLOT DATE: December 1, 2020

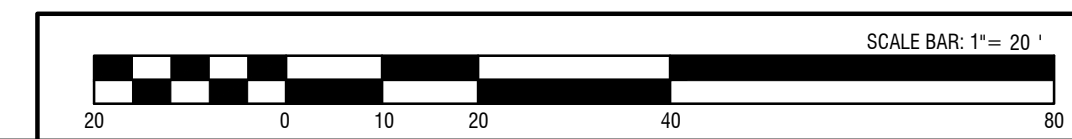

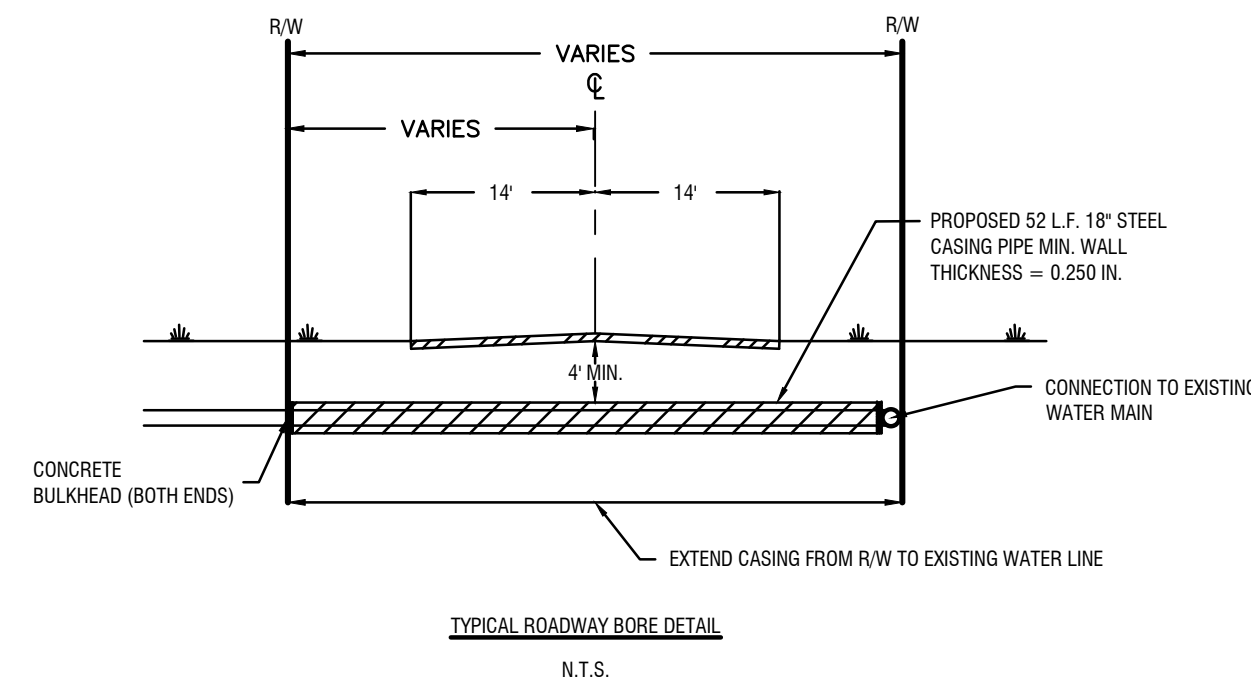

TYPICAL ROADWAY BORE DETAIL  
N.T.S.

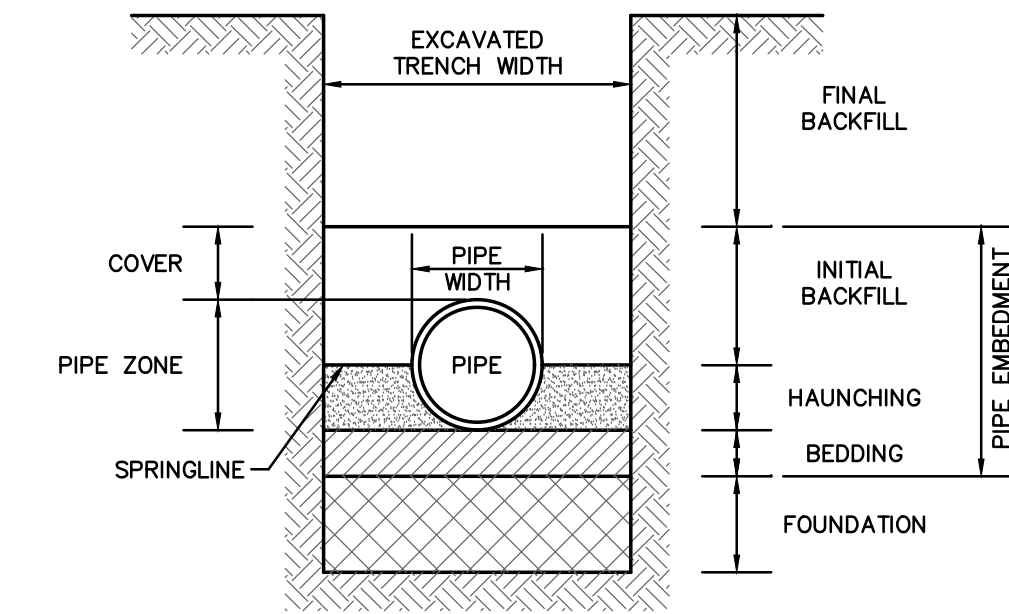

PIPE BEDDING DETAIL  
N.T.S.

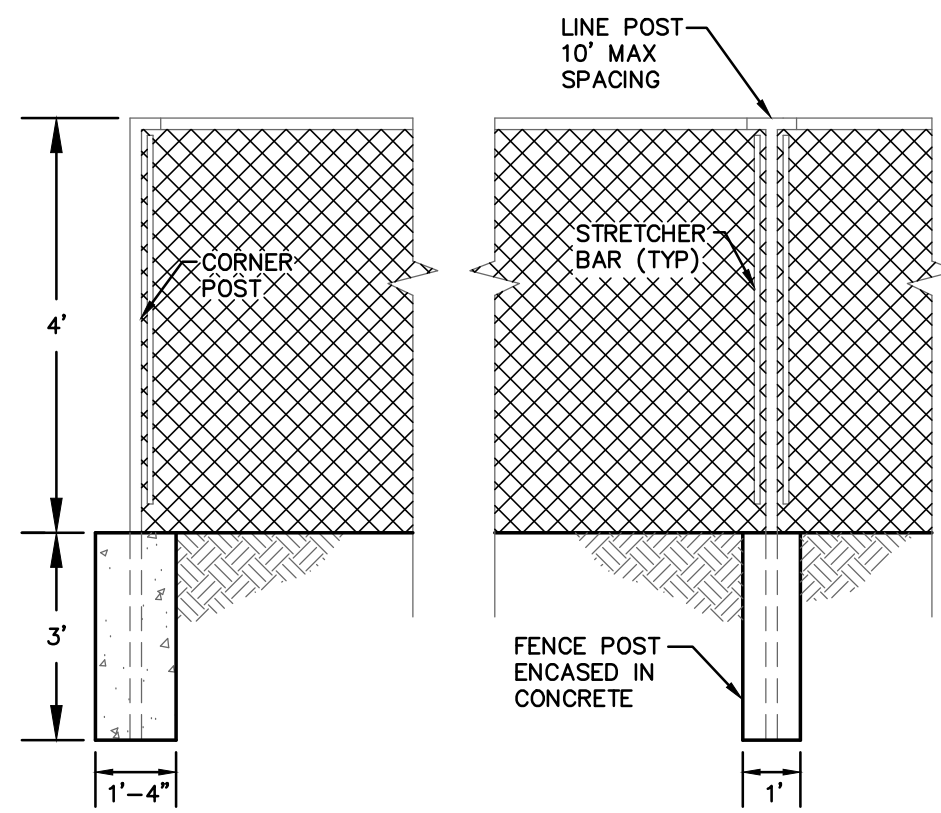

TYPICAL FENCE DETAIL  
N.T.S.

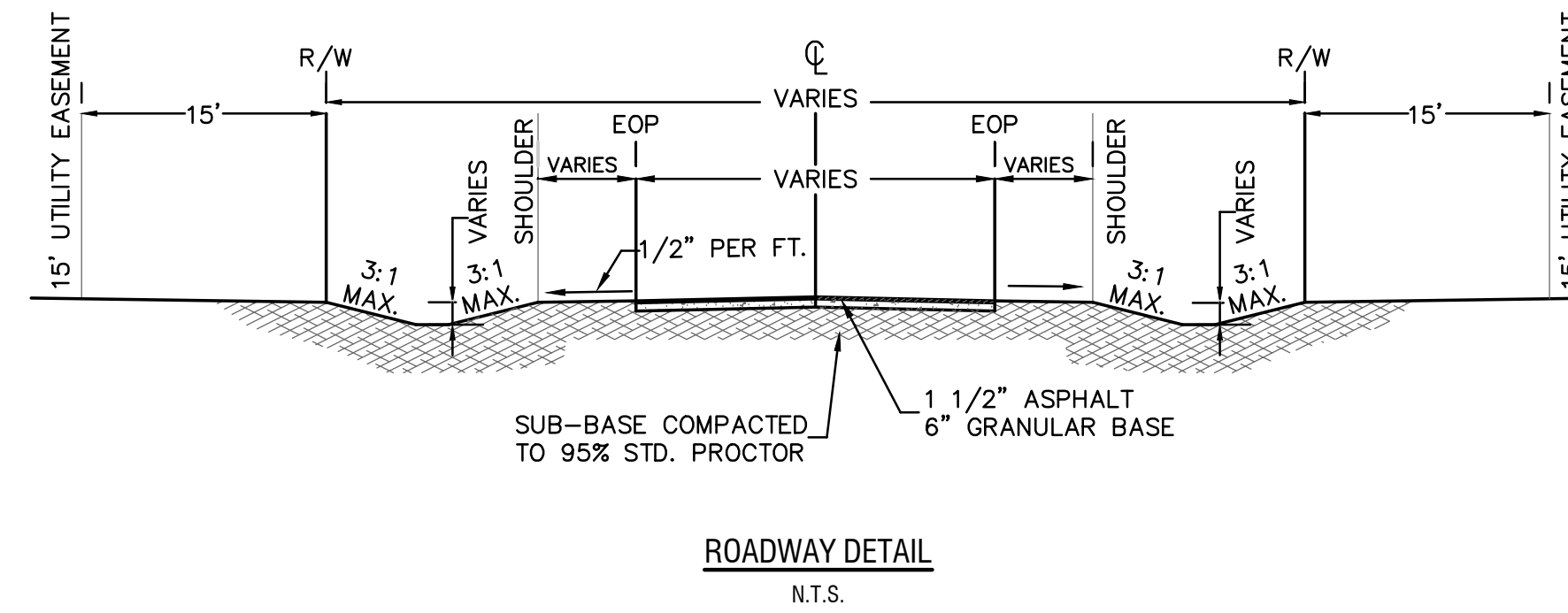

ROADWAY DETAIL  
N.T.S.

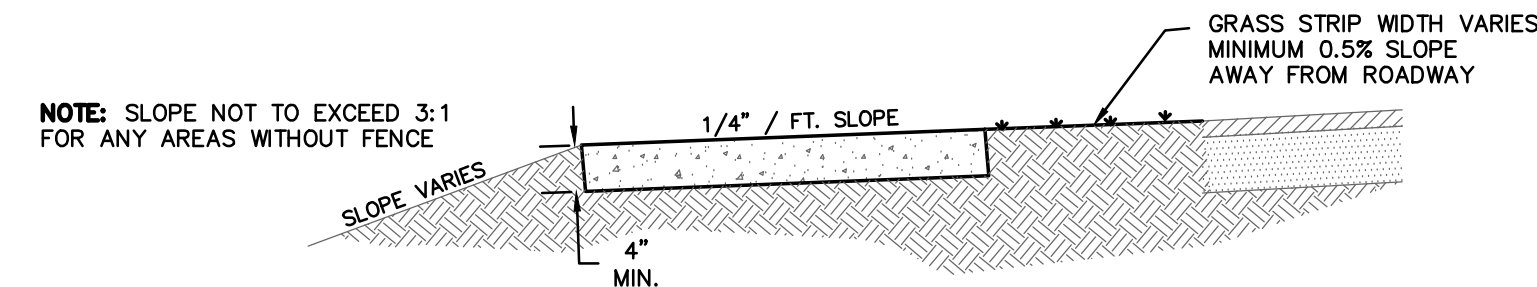

NOTE: SLOPE NOT TO EXCEED 3:1 FOR ANY AREAS WITHOUT FENCE

1/2" THICK EXPANSION JOINT FILLER SHALL BE PLACED A MAXIMUM OF 20' INTERVALS AND AT ALL INTERSECTIONS W/STEPS, CURBS, OR ANY OTHER WALKS ABUTTING STRUCTURES.

FINAL FINISH SHALL BE MEDIUM TO LIGHT BROOM FINISH AND UNIFORM EXCEPT 6" EDGE WITH SMOOTH TROWEL FINISH. ALL EDGES

CONSTRUCTION JOINT DEPTH SHALL BE 1/4 OF THE SLAB THICKNESS AND 1/8" WIDE AND SHALL BE SAWS OR TROWELED WITHIN 24 HOURS OF POURING.

TYPICAL SIDEWALK DETAIL  
N.T.S.

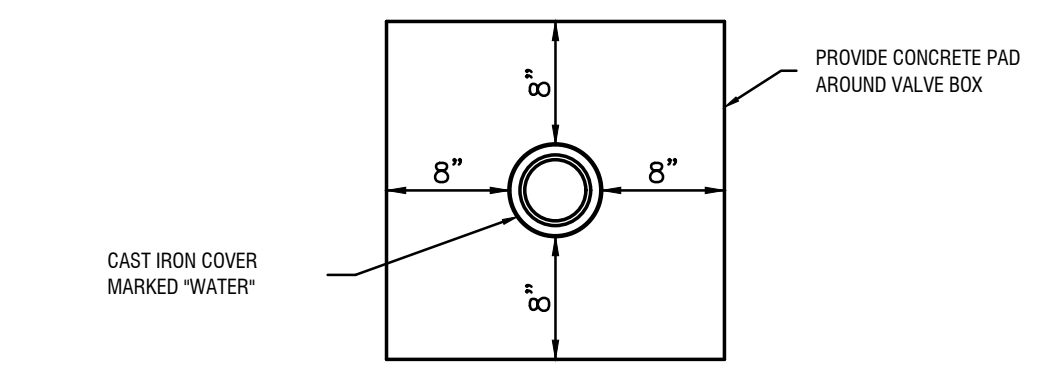

NOTE: IF PRECAST CONCRETE VALVE COLLAR IS USED IN LIEU OF IN PLACE POUR, ANNULAR VOID AROUND VALVE BOX SHALL BE GROUTED TO THE FULL DEPTH OF THE COLLAR.

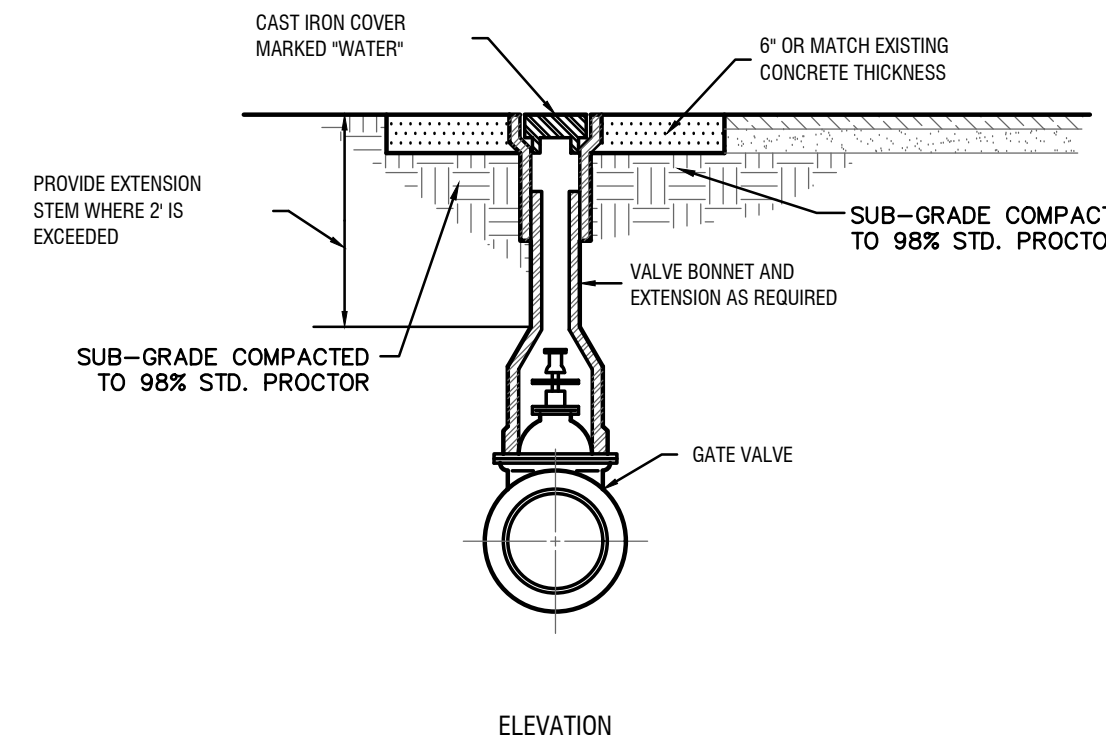

VALVE BOX DETAIL  
N.T.S.

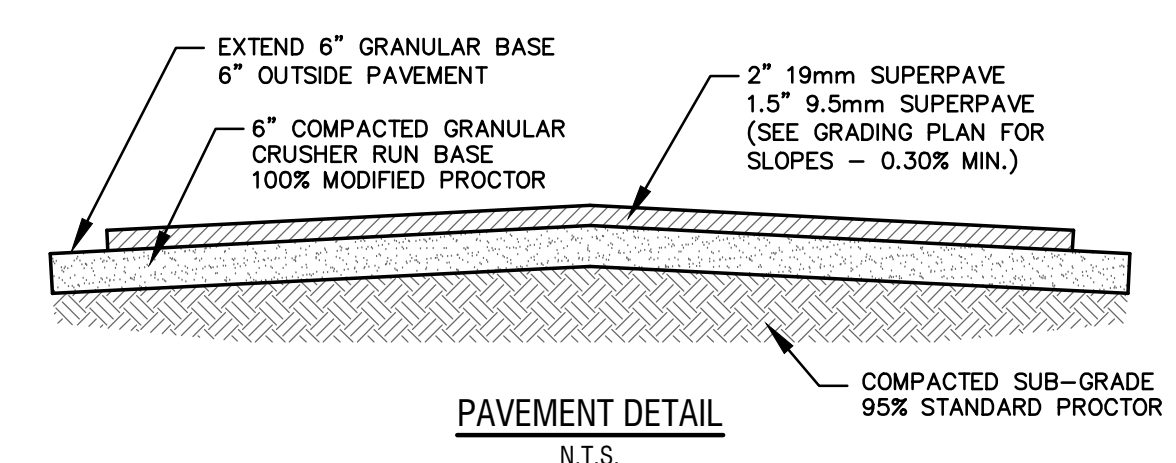

PAVEMENT DETAIL  
N.T.S.

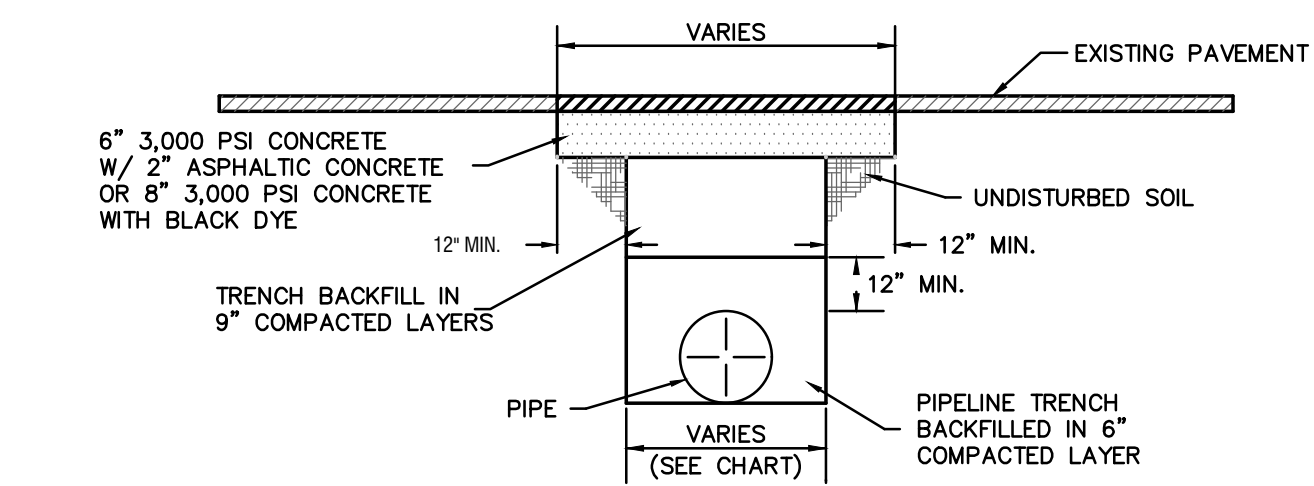

PIPE DIAMETER	MAXIMUM TRENCH WIDTH 0 - 6" CUT DEPTH	MAXIMUM PAVEMENT WIDTH 0 - 6" CUT DEPTH
6" TO 15"	16" + DIA.	40" + DIA.
18" TO 21"	20" + DIA.	44" + DIA.
24" TO 30"	24" + DIA.	48" + DIA.
33" TO 42"	36" + DIA.	60" + DIA.
48"+	36" + DIA.	60" + DIA.

NOTE: MAXIMUM PAVEMENT WIDTH FOR CUT DEPTH OVER 6 FEET SHALL BE 8 FEET UNLESS NOTED OTHERWISE ON PLANS.

PAVEMENT REMOVAL & REPLACEMENT  
N.T.S.

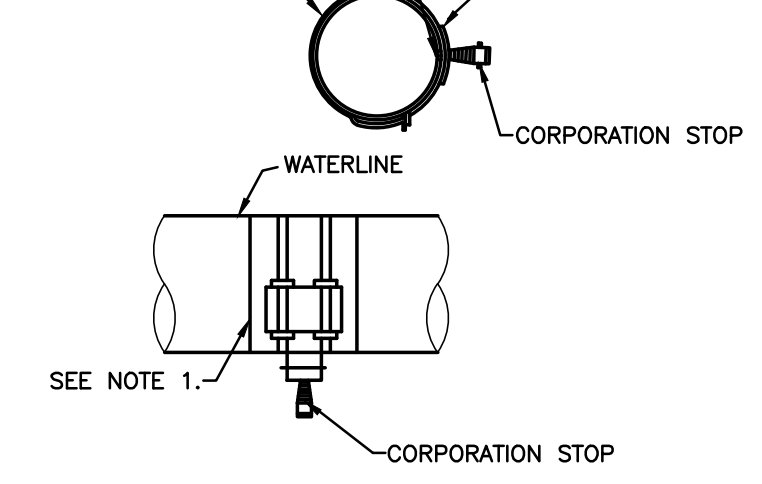
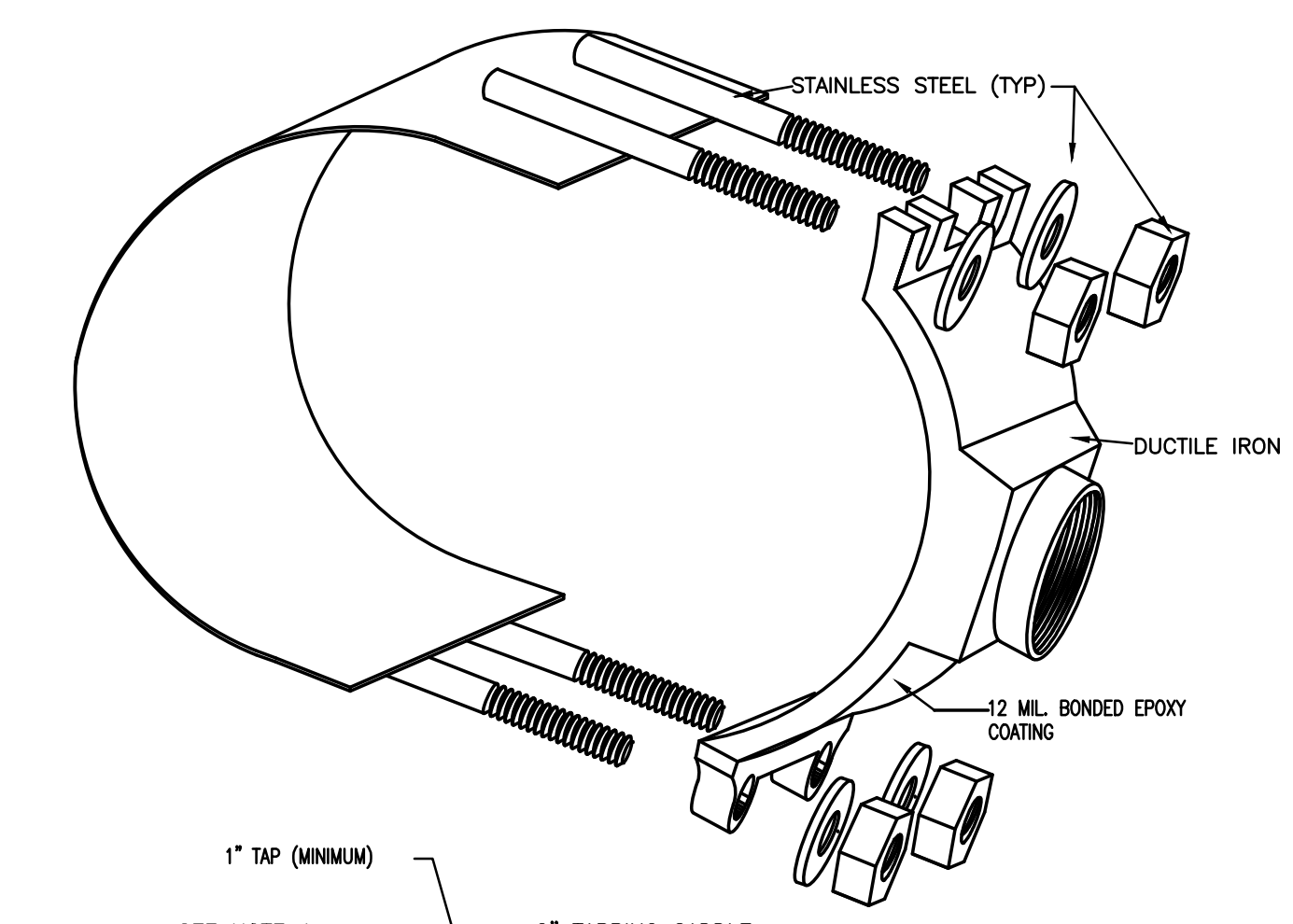

WATER TAPPING SADDLE  
N.T.S.

- NOTES:
1. TAPPING SADDLE TO BE DUCTILE IRON WITH TYPE 304 STAINLESS STEEL FORGED DOUBLE STRAPS, STAINLESS STEEL BOLTS, NUTS, AND WASHERS. FINISH IS FUSION BONDED EPOXY TO AVERAGE THICKNESS OF 12-MILS.
  2. ONE INCH (1") TAPS ON WATER LINES SMALLER THAN SIX INCHES (6") REQUIRE A TAPPING SADDLE. TWO INCH (2") TAPS AND ABOVE REQUIRE A TAPPING SADDLE, REGARDLESS OF WATER MAIN SIZE.
  3. A VALVE BOX SHALL BE USED FOR 2" AND ABOVE CORPORATION STOPS. INSTALL PER DETAIL W4.

REVISIONS:

1.	ADDENDUM TWO 12/01/20
----	-----------------------

THIS DRAWING IS AN INSTRUMENT OF SERVICE AND REMAINS THE PROPERTY OF P.C. SIMONTON & ASSOCIATES, INC. AND M.E. SACK ENGINEERING. IT MAY NOT BE COPIED, ALTERED, OR REPRODUCED IN ANY MANNER WITHOUT PERMISSION ON A SIGNED AND SEALED DOCUMENT. THE INFORMATION CONTAINED HEREIN IS INTENDED FOR THE NAMED CLIENT ONLY. IN THE EVENT OF AN ELECTRONIC VERSION P.C. SIMONTON & ASSOC., INC. AND M.E. SACK ENGINEERING ASSUMES NO RESPONSIBILITY FOR DATA GENERATED, ALTERED OR STATED FROM THIS DRAWING. IN THE EVENT OF A DISPUTE, HARD COPIES WILL TAKE PRECEDENCE OVER ANY ELECTRONIC MEDIA.

DESIGN PROFESSIONAL:  
MARCUS E. SACK

515 NORTH MAIN STREET  
P.O. BOX 649  
HINESVILLE, GA 31313  
TEL: (912) 368-5212

135 GOSHEN ROAD  
SUITE 250  
RINGCON, GA 31326  
TEL: (912) 295-2395

REGISTERED PROFESSIONAL ENGINEER  
MARCUS E. SACK

DATE: 12/01/2020

**M.E. SACK ENGINEERING**

MUNICIPALITY:  
CITY OF PEMBROKE

COUNTY:  
BRYAN COUNTY

Owner:  
CITY OF PEMBROKE  
160 N MAIN ST  
PEMBROKE, GA 31321  
(912) 653-4413  
STREETS@PEMBROKEGA.NET

24 HOUR CONTACT:  
CITY OF PEMBROKE  
160 N MAIN ST  
PEMBROKE, GA 31321  
(912) 653-4413  
STREETS@PEMBROKEGA.NET

Pembroke City  
Street Improvements

DETAILS

**C500**

FILE NO: 2020-35  
PLOT DATE: December 1, 2020