



515 N. Main Street | Hinesville, GA 31313
PO Box 649 | Hinesville, GA 31310
912.368.5212
www.mesack.com
ME Sack Engineering
@mesackengineering
mesack



ADDENDUM No. ONE

Date: April 10, 2025

Project: East Side Park Remodel, MES No. 2023-66

Engineer: M.E. Sack Engineering 
Hinesville, Georgia

The original plans, specifications, and bid documents are amended to include the following:

Table of Contents:

- Replace the second page of the original Table of Contents (TOC) with the enclosed of the same. Note that Appendix F. RCP Shelters, Inc. and its subheadings have been added.

Appendices:

- Include the enclosed Appendix F. RCP Shelters, Inc. and its subheadings to the original Bid Document.

The following clarification is offered for questions received:

1. *Multiple places on the drawings reference "RCP Shelters, Inc. Drawing LW-BS-W353963-Z and RCP Proposal 40999.R1. Will this information be made available to the Bidding Contractors?*
 - Yes. The information is included in this document.

-END-

	SECTION 02821	Grassing	
	SECTION 03300	Concrete, General	
	SECTION 15100	Valves (Water)	
	SECTION 32 18 16.16	Artificial Grass Sports Field	
E.	Electrical Specifications		V-E
	SECTION 26 000	Common Work Results for Electrical	
	SECTION 26 005	Electrical Submittal Procedures	
	SECTION 26 0519	Low-Voltage Electrical Conductors	
	SECTION 26 0526	Grounding and Bonding	
	SECTION 26 0529	Hangers and Supports for Electrical Systems	
	SECTION 26 0533	Raceways and Boxes for Electrical Systems	
	SECTION 26 0553	Electrical Identification	
	SECTION 26 0943	Distributed Digital Lighting Control System	
	SECTION 26 2416	Panelboards	
	SECTION 26 2726	Wiring Devices	
	SECTION 26 2816	Enclosed Switches and Circuit Breakers	
	SECTION 26 4000	Outdoor Sports Field Lighting	
	SECTION 26 4313	Surge Protection for Low-Voltage Electrical Power Circuits	
	SECTION 26 5116	Interior Lighting	
F.	RCP Shelters, Inc.		V-F
	Preliminary Concept Drawing LW-BS-W353963-Z		V-F1
	Proposal #40999.R1		V-F2

F. RCP SHELTERS, INC

F1. PRELIMINARY CONCEPT DRAWING LW-BS-W353963-Z

PRELIMINARY DRAWING — NOT FOR CONSTRUCTION

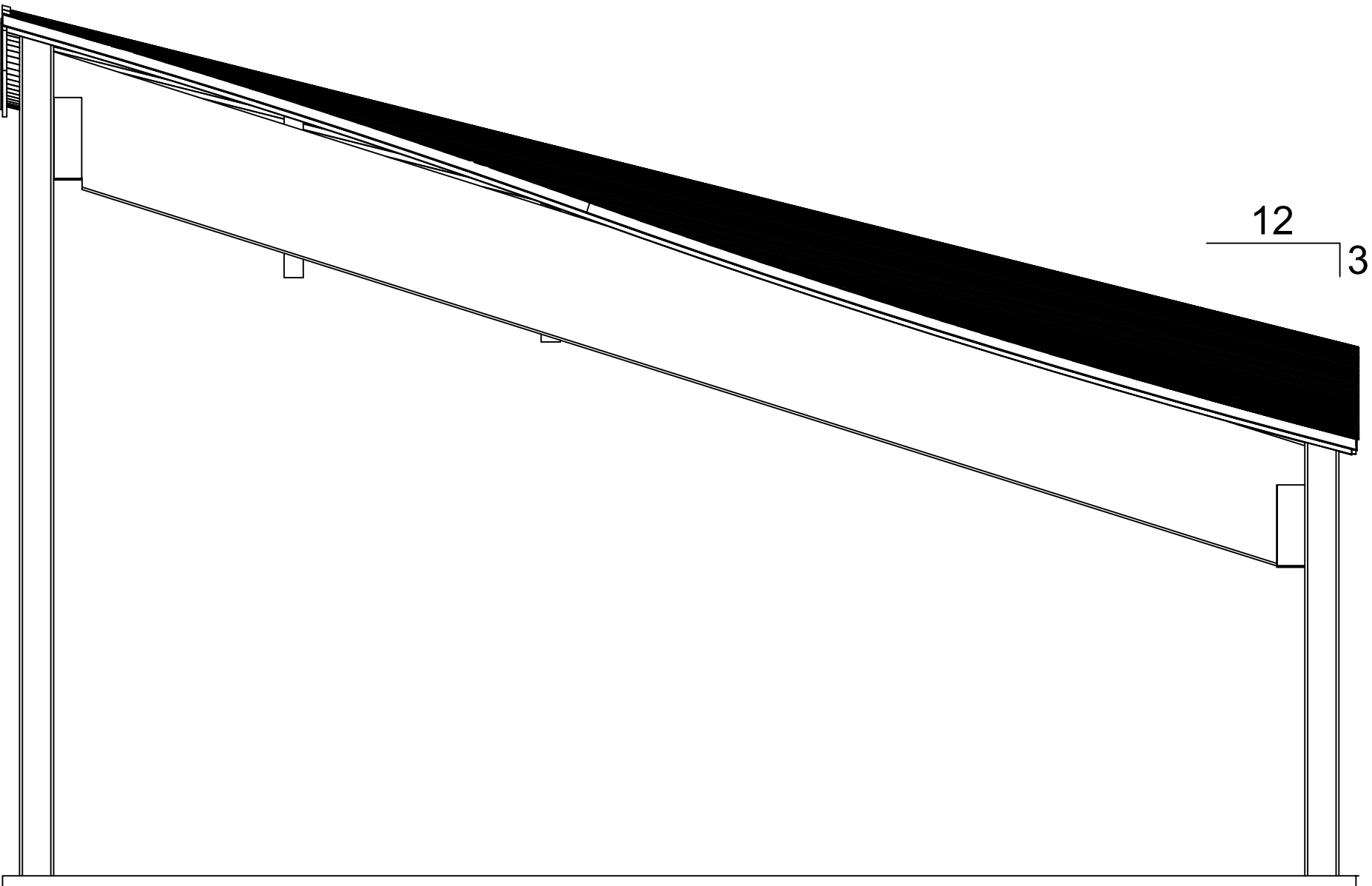
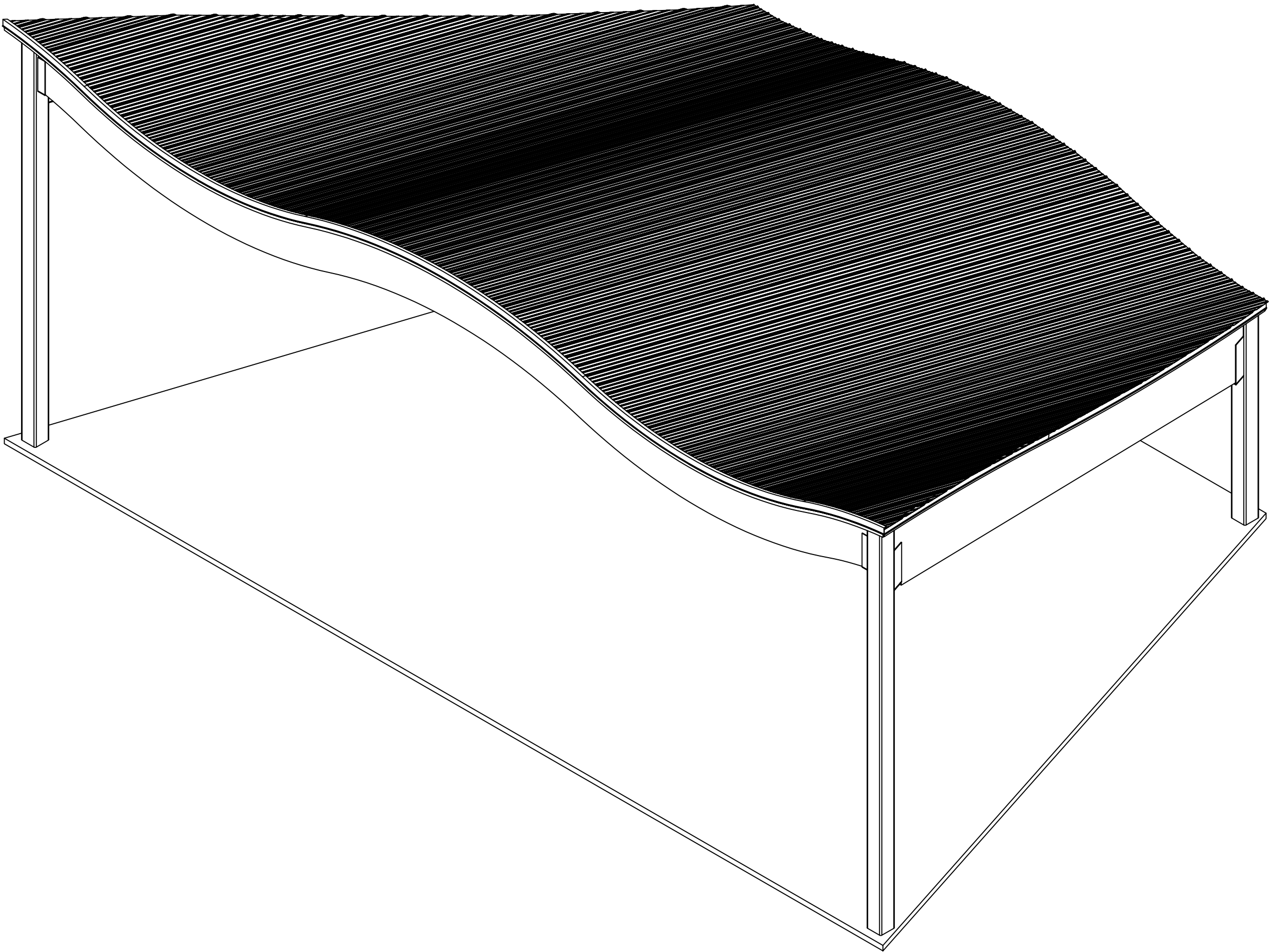
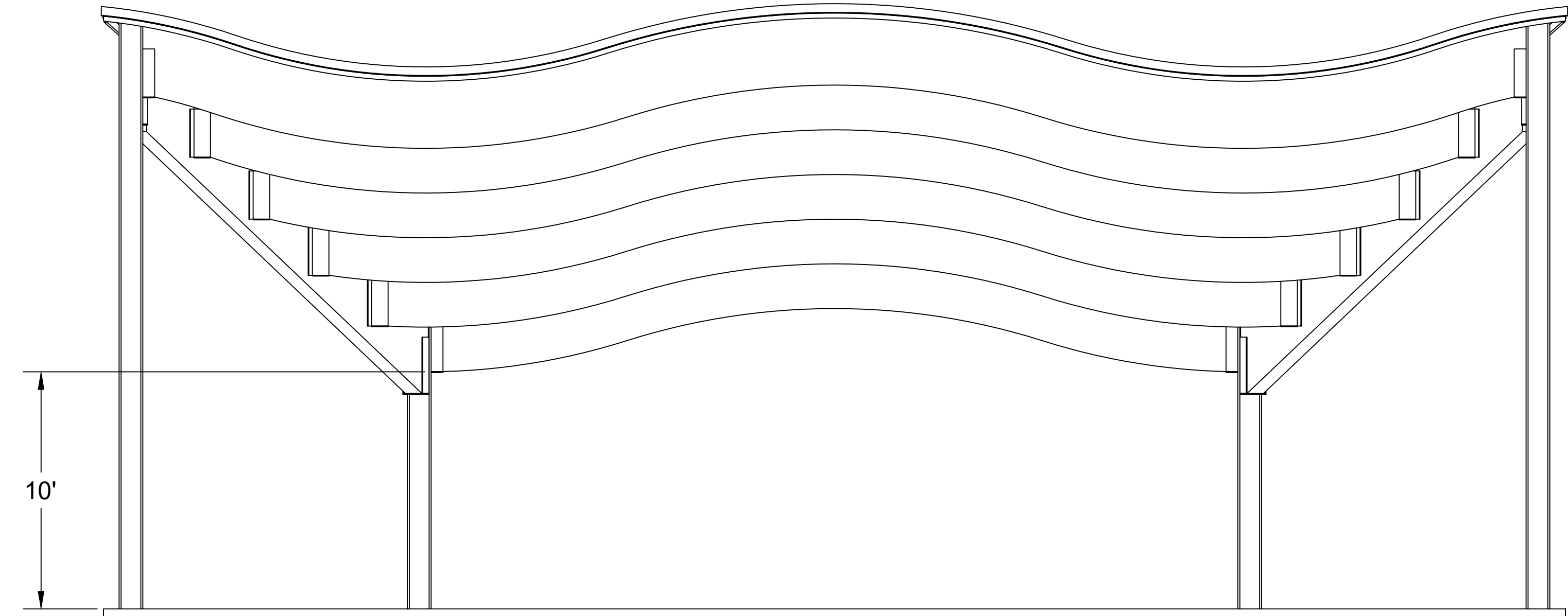
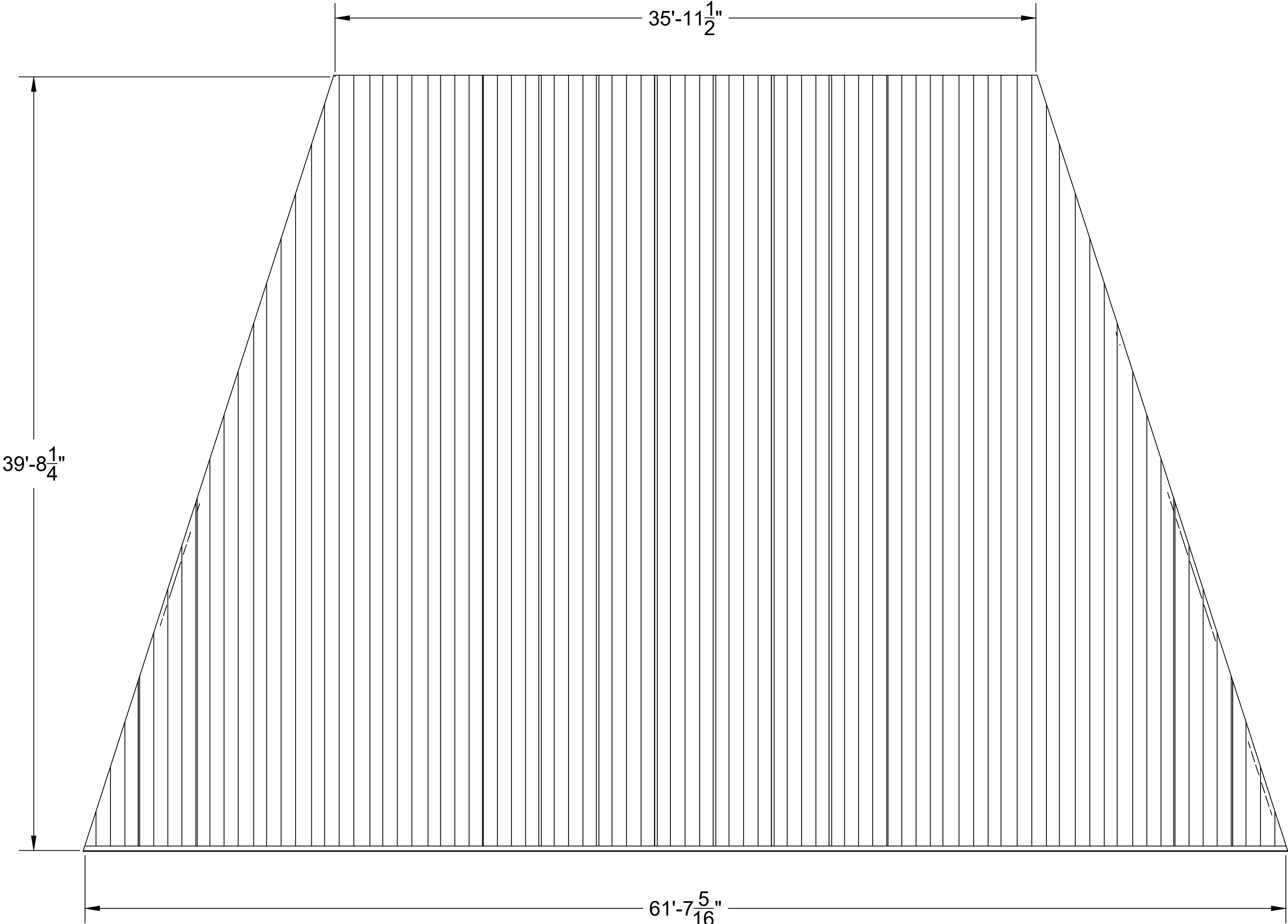

THIS PRINT IS THE PROPERTY OF RCP SHELTERS AND IS NOT TO BE USED, COPIED, OR REPRODUCED WITHOUT THEIR EXPRESSED WRITTEN PERMISSION.

LW-BS-W353963-Z

NUMBER OF PURLINS MAY VARY DEPENDING UPON DESIGN LOADS. SIZES AND SPACING OF PURLINS TO BE DETERMINED DURING FINAL DESIGN.

RCP SHELTERS, INC.

2100 SE RAYS WAY STUART, FL 34984 PO BOX 25 STUART, FL 34985-0025

■ SHELTERS ■ PAVILIONS ■ CONCESSIONS ■ KIOSKS ■ FABRIC SHADE ■ RESTROOMS ■ BANDSHELLS ■ MINI-SHELTERS ■ DUGOUTS ■ FABRIC SAIL

Phone 800-525-0207 Fax 772-288-0207

Email info@rcpselters.com

www.rcpselters.com

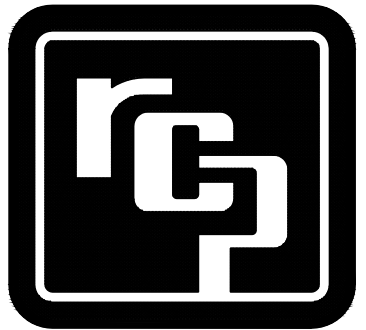

PROJ. NO.:

DRAWN:

CHK'D:

REV 1:

REV 2:

REV 3:

REV 4:

REV 5:

CAD NO.:

EEC JOB NO.:

SHEET NO.:

PRELIMINARY DRAWING – NOT FOR CONSTRUCTION

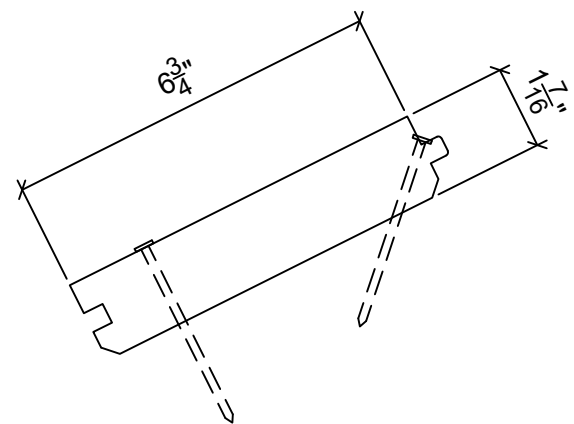

DECK ATTACHMENT DETAIL

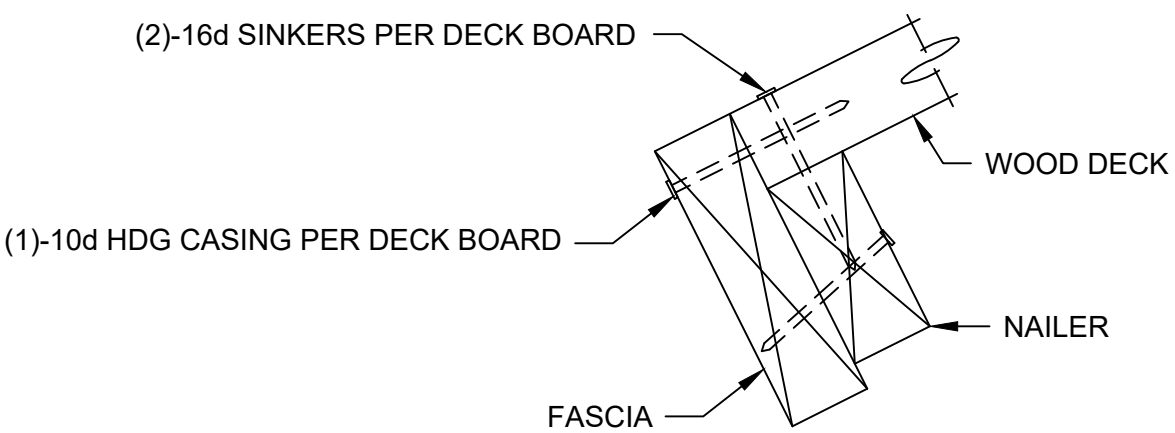

FASCIA ATTACHMENT DETAIL

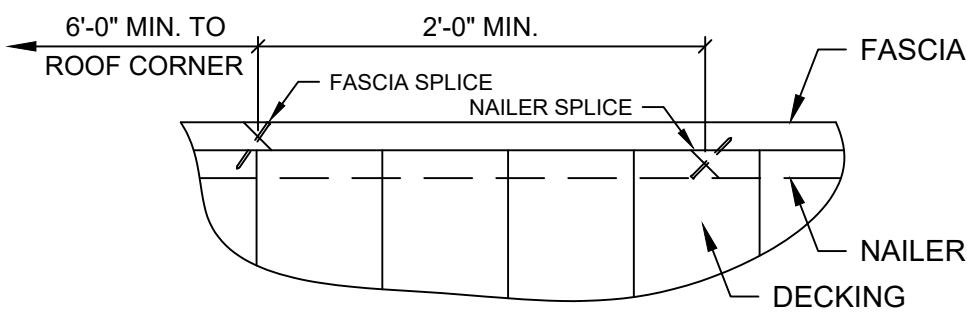

FASCIA SPLICE DETAIL

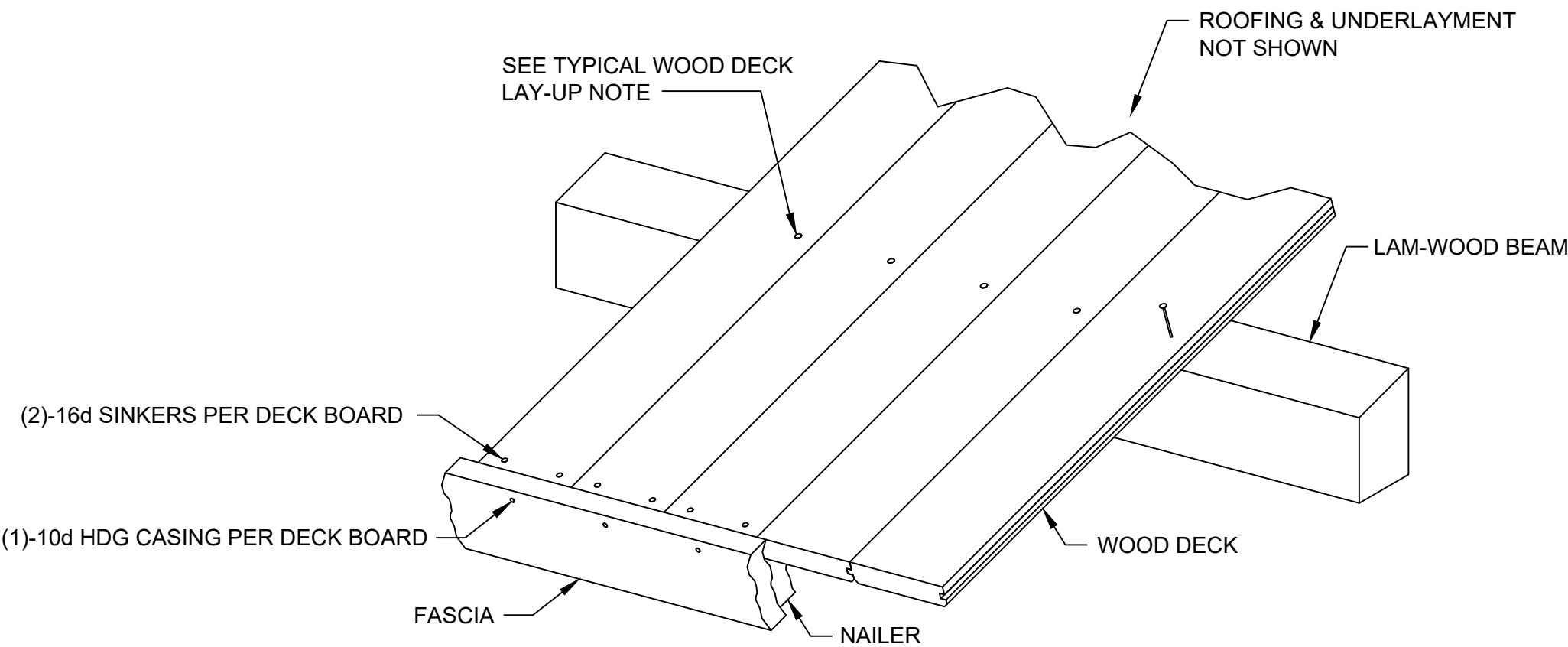

FASCIA NOTES:

1. ALL FASCIA CORNERS AND SPLICES ARE TO BE MITERED.
2. SEE DETAIL A FOR SPLICE DETAIL.
3. ATTACH FASCIA WITH 10d HDG CASING NAILS:
 - a. TO 2x4 NAILER - 24" O.C.
 - b. TO BEAM ENDS - 3 NAILS PER FASCIA
 - c. TO ENDS OF ROOF DECKING - 1 NAIL PER DECK BOARD
 - d. AT CORNERS - 2 NAILS EACH DIRECTION
 - e. OTHER LOCATIONS - 24" O.C. TO ROOF DECKING

2 x 4 NAILER

- A. MITER ALL SPLICES
- B. NAIL SPLICES TOGETHER WITH (2) 10d HDG CASING NAILS, DRIVE NAILS AT AN ANGLE TO AVOID PUNCHING THRU FASCIA.

TYPICAL DECK LAY-UP

1. START LAYING DECK AT CORNER W/ TONGUES OUTWARD IN DIRECTION OF LAYING.
2. DRIVE COURSES TIGHT W/ BLOCKING.
3. TOE NAIL & FACE NAIL AT EACH SUPPORT (BEAMS) USING 16d COMMON NAILS.

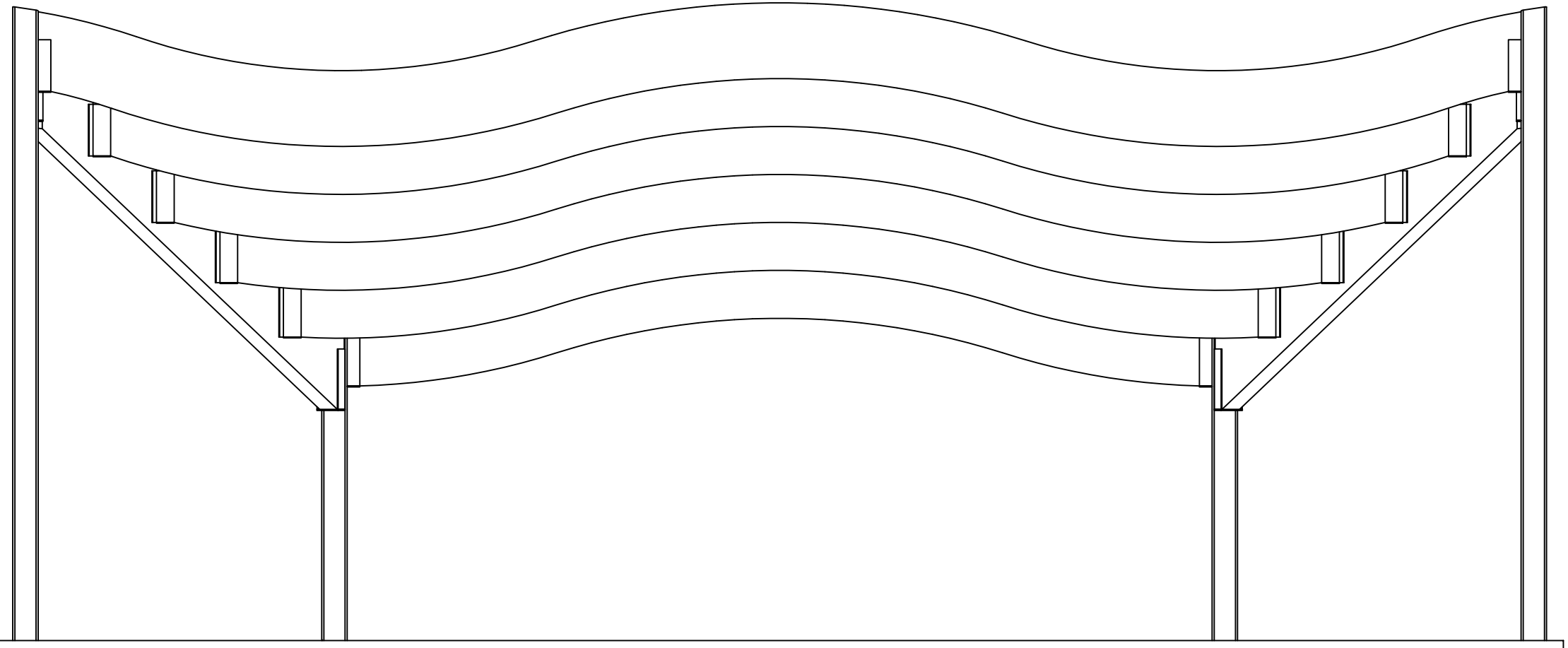
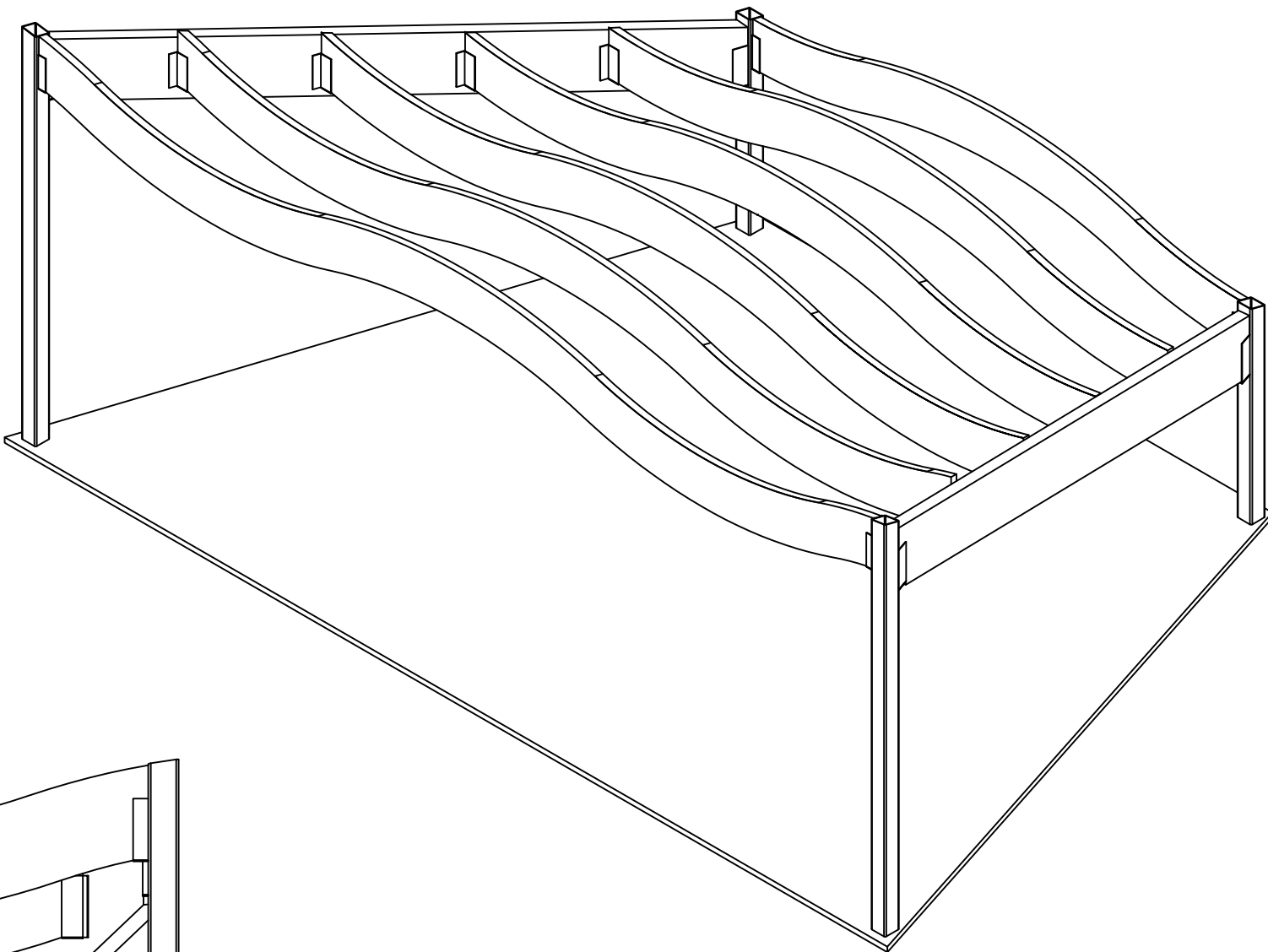
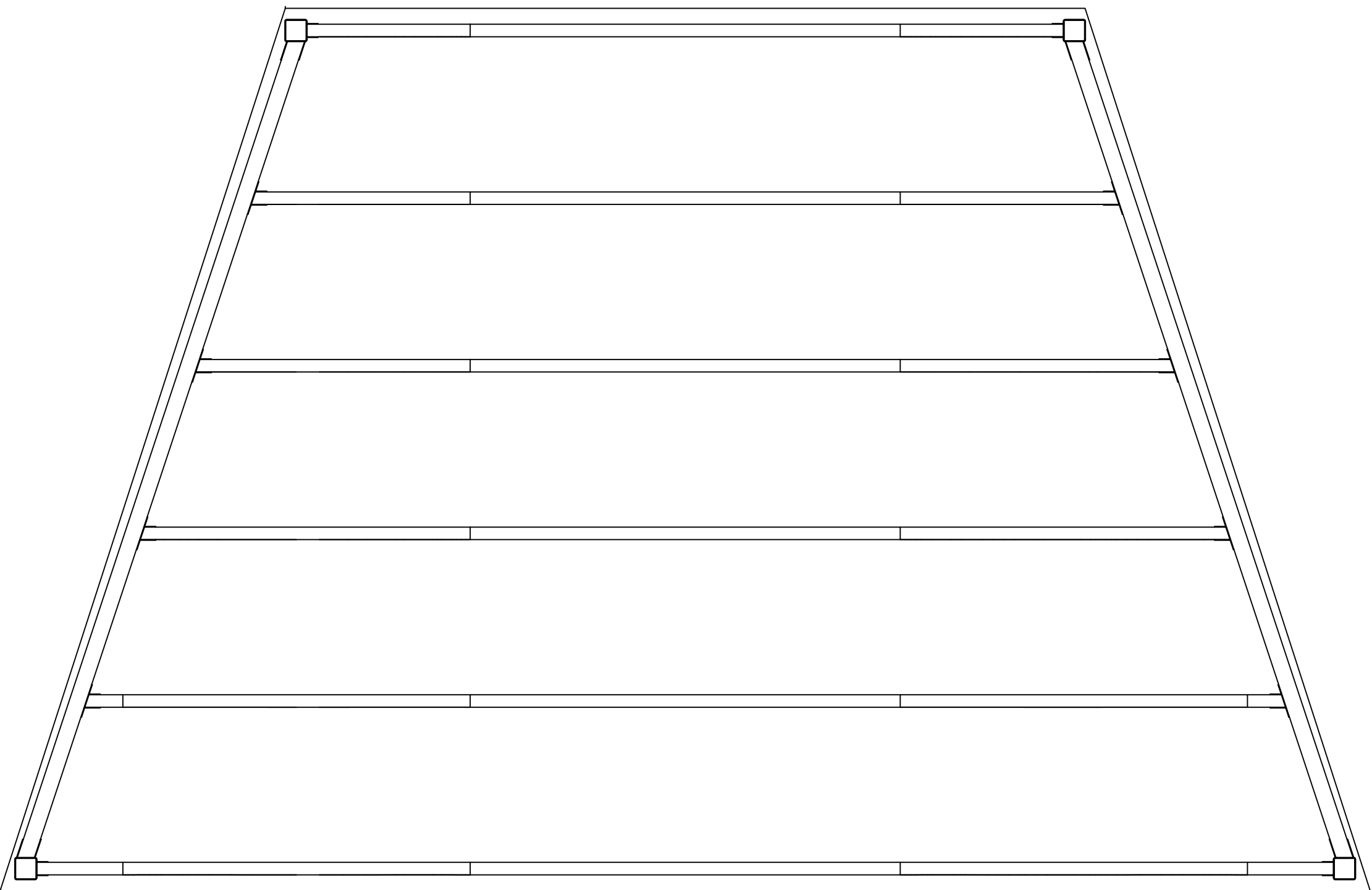

THIS PRINT IS THE PROPERTY OF RCP SHELTERS AND IS NOT TO BE USED, COPIED, OR REPRODUCED WITHOUT THEIR EXPRESSED WRITTEN PERMISSION.

LW-BS-W353963-Z

NUMBER OF PURLINS MAY VARY DEPENDING UPON DESIGN LOADS. SIZES AND SPACING OF PURLINS TO BE DETERMINED DURING FINAL DESIGN.

RCP SHELTERS, INC.

2100 SE RAYS WAY STUART, FL 34994 PO BOX 25 STUART, FL 34995-0025

■ SHELTERS ■ PAVILIONS ■ CONCESSIONS ■ KIOSKS ■ FABRIC SHADE
■ RESTROOMS ■ BANDSHELLS ■ MINI-SHELTERS ■ DUGOUTS ■ FABRIC SAIL

Phone 800-525-0207 Fax 772-288-0207

www.rcpshelters.com Email info@rcpshelters.com

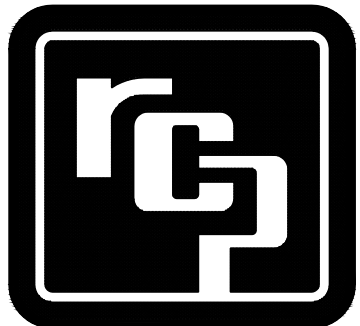

PROJ. NO.:

DRAWN:

CHK'D:

REV 1:

REV 2:

REV 3:

REV 4:

REV 5:

CAD NO.:

EEC JOB NO.:

SHEET NO.:

PRELIMINARY DRAWING – NOT FOR CONSTRUCTION

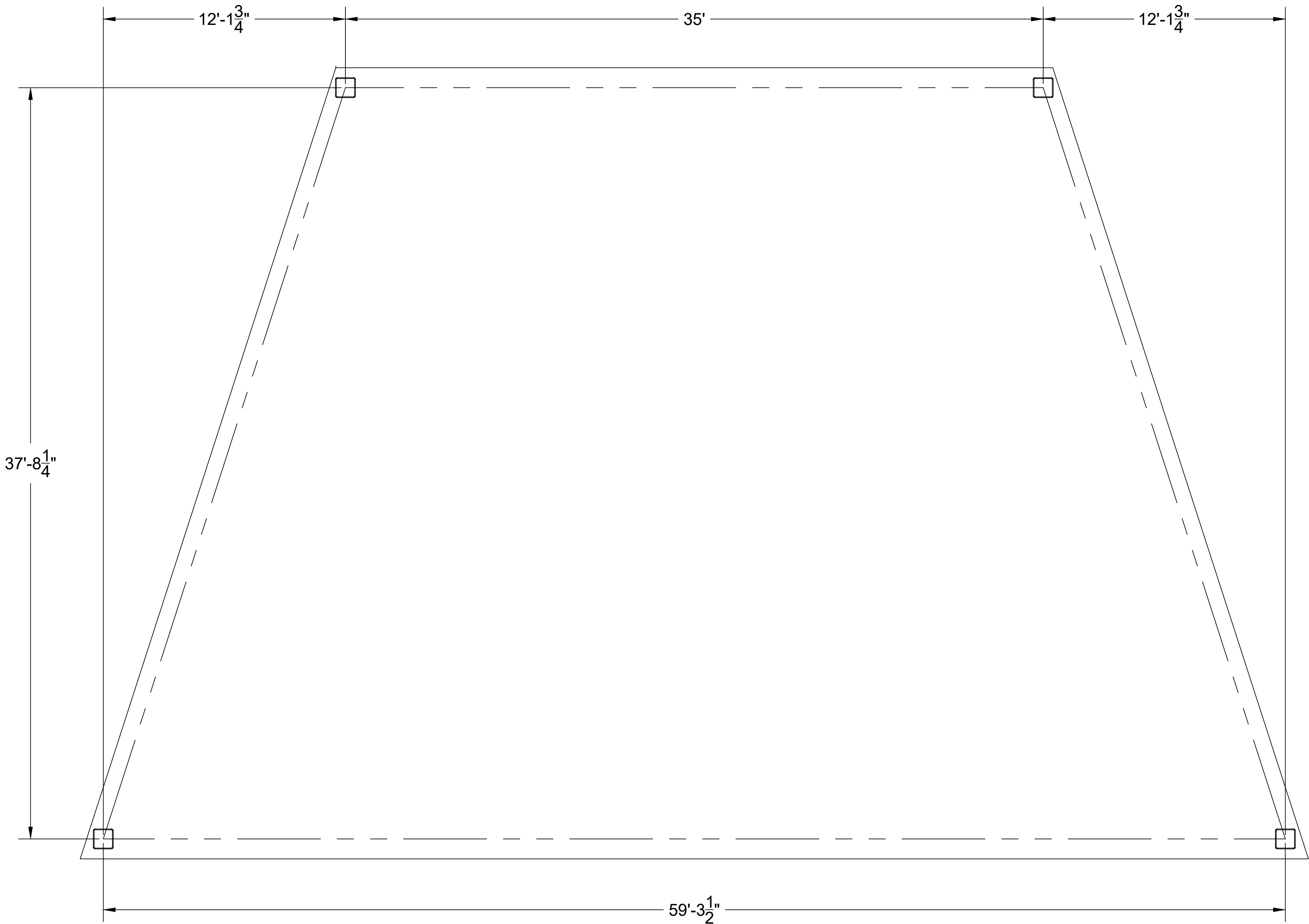

THIS PRINT IS THE PROPERTY OF RCP SHELTERS AND IS NOT TO BE USED, COPIED, OR REPRODUCED WITHOUT THEIR EXPRESSED WRITTEN PERMISSION.

LW-BS-W353963-Z

NUMBER OF PURLINS MAY VARY DEPENDING UPON DESIGN LOADS. SIZES AND SPACING OF PURLINS TO BE DETERMINED DURING FINAL DESIGN.

RCP SHELTERS, INC.

2100 SE RAYS WAY STUART, FL 34994 PO BOX 25 STUART, FL 34985-0025

■ SHELTERS ■ PAVILIONS ■ CONCESSIONS ■ KIOSKS ■ FABRIC SHADE
■ RESTROOMS ■ BANDSHELLS ■ MINI-SHELTERS ■ DUGOUTS ■ FABRIC SAIL

Phone 800-525-0207 Fax 772-288-0207

www.rcpselters.com Email info@rcpselters.com

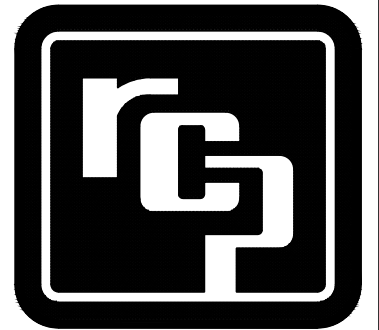

PROJ. NO.:

DRAWN:

CHK'D:

REV 1:

REV 2:

REV 3:

REV 4:

REV 5:

CAD NO.:

EEC JOB NO.:

SHEET NO.:

F2. PROPOSAL #40999.R1

Proposal #: 40999.R1
Date: 10/28/2024

RCP SHELTERS, INC.
PROPOSAL/ORDER FORM



Greenline Architecture

Attn: James Keim
28 E. 35th Street
Savannah, GA 31401
Phone: 912-447-5665
E-mail: jkeim@greenlinearch.com

2100 SE Rays Way • Stuart, FL 34994
P: 800-525-0207 • 772-288-3600
info@rcpshelters.com • http://www.rcpshelters.com

Prepared by: Kyle Ritter • kyle@rcpshelters.com

Community Park - Alamo, GA

ITEM	QTY	DESCRIPTION	EXTENDED PRICE
A	1.00	Model #: LW-BS-W394168-Z Custom 39'-9" Wide Rear x 41'-8" Deep x 68'-6" Wide Front Lam-Wood Wave Bandshell	\$179,065.00
FREIGHT	Pooled freight rate delivered to an accessible site. Refer to notes on page 2 for more details.		Included
SALES TAX	CA or FL sales tax to be added unless tax exemption is provided. For all other states, purchaser is responsible for sales tax to appropriate authorities.		
TOTAL	Total of Item(s) and option(s) selected and freight (if applicable)		

INCLUDED

- GA Cert Drawings: includes standard RCP foundation design
- Columns: powder coated tube steel
- Beams: glued laminated Southern Yellow Pine
- Roofing: 26-ga. Max-Rib (underlayment, trim, hardware)
- Roof Deck: #1 grade 2x8 T&G Southern Yellow Pine
- Fascia: #1 grade 2x6 Alaskan Yellow Cedar
- Stain: factory stained exposed wood
- Hardware: powder coated connections
- Fasteners: hot-dipped galvanized
- Eave Height: 10'-0" ±
- Electrical cutouts
- OSB diaphragm (may be structurally required)
- Delivery: to an accessible site

NOT INCLUDED

- Stage design
- Column wraps
- Anchor bolts & templates
- Unloading
- Concrete
- Concrete embedment (wire mesh, rebar, etc.)
- Installation
- Deck & fascia nails
- Anything not specifically listed as "Included"

TERMS & CONDITIONS

- Orders not subject to cancellation
- 30% deposit due with order
- Balance due prior to shipment
 - Net 30 available with approved credit (*check only*)
- 3% discount for payment in full with order (*check only*)

DIRECT PO TO RCP FROM GOVERNMENT AGENCIES

- Net 30
- 1% discount net 10
- no deposits required

PRICING NOTES (RCP reserves the right to requote if:)

- Quote is older than 30 days
- Purchaser drawing approval exceeds 30 days
- Purchaser delays original ship date 30+ days
- Project location snow load exceeds 25 psf

(Signature)

(Print/Title)

(Date)

Signature confirms acceptance of all pages of this proposal.



Proposal #: 40999.R1

Community Park - Alamo, GA

PROPOSAL NOTES & DETAILS

PROPOSAL INFORMATION/NOTES

- The proposal is based on design by RCP Shelters, not necessarily an exact match to bid or architectural drawings.
- Lead times may vary significantly based on design complexity, seasonal demand, and current backlog.
- Simple material supplier PO or signed proposal/order form are acceptable for ordering. PO legalese will be rejected.
- RCP Shelters does not accept orders with contingent liability or liquidated damages.

DESIGN / ENGINEERING

- RCP value engineers for the minimum number framing members to minimize cost and provide structures as open and accessible as possible. Final design may not reflect the same number members, sizes, or spacing as images on RCP's website and catalog or preliminary or bid drawings.
- Design requirements not disclosed to RCP prior to proposal or required revisions resulting from information not previously disclosed are subject to additional fees. Common examples are site-specific requests/requirements and pertinent foundation information, including but not limited to geotechnical reports, foundation depth limitations, epoxy anchor design, or installations near or connected to other structures causing drift snow loads.
- Standard cylindrical shaped foundation design, minimum 24" diameter, based on assumed soil values, is included. Alternate or custom foundations may be designed by others, with column base reactions provided by RCP.
- RCP's anchor bolt option is valid only for foundations designed by RCP.
- Local code may have requirements that are not the responsibility of RCP.
- Each project is designed for its specific location after receipt of order. Occasionally, engineering determines that materials not included in the proposal are required. Such materials shall be provided by others.
- Drawings provided by RCP Shelters with this proposal are preliminary and are not for construction. For complete project specific details, engineered drawings can be purchased separately without obligation to purchase the structure.

FABRICATION / SHIPPING DETAILS

- Shipping dates are not guaranteed.
- Freight is priced based on pooled loads to a location accessible by a flatbed semi-trailer.
- Upgrade to dedicated truck or split shipment is available for an additional fee.
- Trucking will call at least 24 hours prior to delivery to coordinate.
- Offloading by others. Materials must be stored off the ground and kept dry.

(Signature)

(Print/Title)

(Date)

Signature confirms acceptance of all pages of this proposal.