

VICINITY MAP  
NOT TO SCALE

**PATRIOT TRAIL QUANTITY ESTIMATES:**

- 1.5" MILLING OF ASPHALT SURFACE COURSE: 2,443 SY
- 1.5" 9.5mm SUPERPAVE ASPHALT SURFACE COURSE: 2,443 SY
- ADJUST WATER VALVE BOX TOP: 1 EA
- 5" DOUBLE SOLID YELLOW STRIPING: 645 LF
- 5" SOLID WHITE STRIPING: 1448 LF

\*QUANTITIES ARE ESTIMATES ONLY, LUMP SUM ITEMS IN BID DOCUMENTS SHALL BE INCLUSIVE OF ON SITE CONDITIONS.

DRAWING COMPLETED BY: CHRIS HEROLD

REVISIONS:

|  |
|--|
|  |
|  |
|  |
|  |
|  |
|  |
|  |
|  |
|  |
|  |

\*THIS DRAWING IS AN INSTRUMENT OF SERVICE AND REMAINS THE PROPERTY OF P.C. SIMONTON & ASSOCIATES, INC. AND M.E. SACK ENGINEERING. IT MAY NOT BE COPIED, ALTERED, OR REPRODUCED IN ANY MANNER WITHOUT PERMISSION ON A SIGNED AND SEALED DOCUMENT. THE INFORMATION CONTAINED HEREIN IS INTENDED FOR THE NAMED CLIENT ONLY. IN THE EVENT OF AN ELECTRONIC VERSION P.C. SIMONTON & ASSOC., INC. AND M.E. SACK ENGINEERING ASSUMES NO RESPONSIBILITY FOR DATA GENERATED, ALTERED OR STAKED FROM THIS DRAWING. IN THE EVENT OF A DISPUTE, HARD COPIES WILL TAKE PRECEDENCE OVER ANY ELECTRONIC MEDIA.\*

DESIGN PROFESSIONAL  
MARCUS E. SACK

515 NORTH MAIN STREET  
P.O. BOX 649  
HINESVILLE, GA 31313  
TEL: (912) 368-5212



MUNICIPALITY:  
CITY OF FLEMINGTON

COUNTY:  
LIBERTY COUNTY

OWNER:  
CITY OF FLEMINGTON -  
MAYOR PAUL HAWKINS  
156 OLD SUNBURY ROAD  
FLEMINGTON, GA 31313  
PHONE: (912) 876-3223

JOB NO.: 2025-10 PRJ

CITY OF FLEMINGTON  
2025 LMIG  
OVERLAY EXHIBIT

C1

PLOT DATE: February 3, 2026

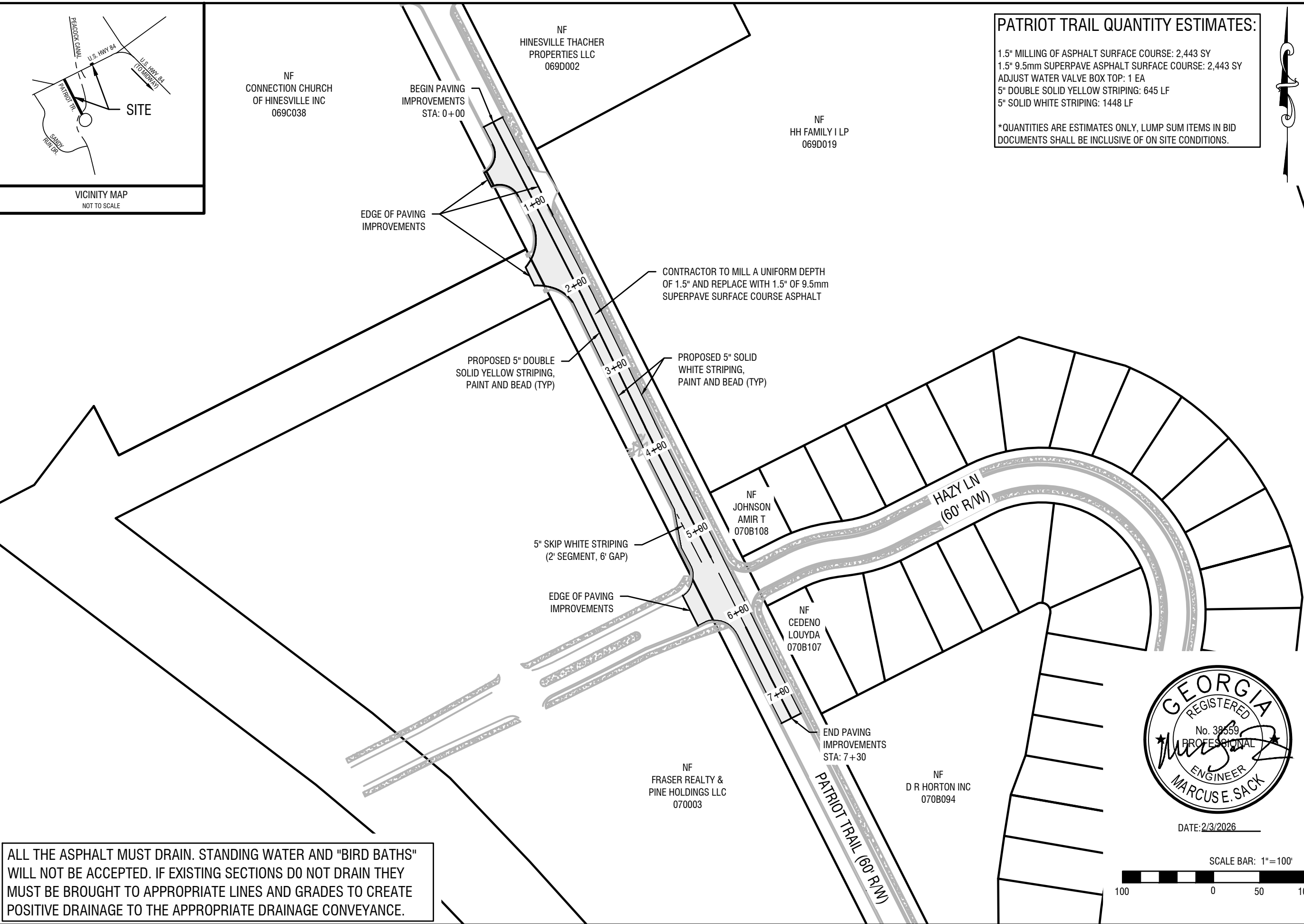

ALL THE ASPHALT MUST DRAIN. STANDING WATER AND "BIRD BATHS" WILL NOT BE ACCEPTED. IF EXISTING SECTIONS DO NOT DRAIN THEY MUST BE BROUGHT TO APPROPRIATE LINES AND GRADES TO CREATE POSITIVE DRAINAGE TO THE APPROPRIATE DRAINAGE CONVEYANCE.



DATE: 2/3/2026



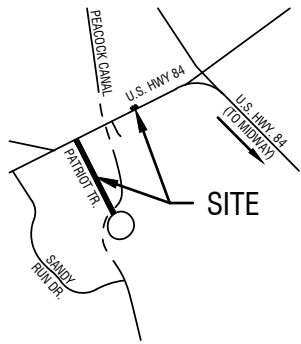

VICINITY MAP  
NOT TO SCALE

**TRANQUIL WAY QUANTITY ESTIMATES:**

- REMOVE SINGLE-WING CURB INLET TOP: 1 EA
- PROPOSED GRATE INLET AND FRAME: 1 EA
- CONCRETE CURB: 11 LF
- CONCRETE GUTTER: 1 SY

\*QUANTITIES ARE ESTIMATES ONLY, LUMP SUM ITEMS IN BID DOCUMENTS SHALL BE INCLUSIVE OF ON SITE CONDITIONS.

DRAWING COMPLETED BY: CHRIS HEROLD

REVISIONS:

|  |
|--|
|  |
|  |
|  |
|  |
|  |
|  |
|  |
|  |

\*THIS DRAWING IS AN INSTRUMENT OF SERVICE AND REMAINS THE PROPERTY OF P.C. SIMONTON & ASSOCIATES, INC. AND M.E. SACK ENGINEERING. IT MAY NOT BE COPIED, ALTERED, OR REPRODUCED IN ANY MANNER WITHOUT PERMISSION ON A SIGNED AND SEALED DOCUMENT. THE INFORMATION CONTAINED HEREIN IS INTENDED FOR THE NAMED CLIENT ONLY. IN THE EVENT OF AN ELECTRONIC VERSION P.C. SIMONTON & ASSOC., INC. AND M.E. SACK ENGINEERING ASSUMES NO RESPONSIBILITY FOR DATA GENERATED, ALTERED OR STAKED FROM THIS DRAWING. IN THE EVENT OF A DISPUTE, HARD COPIES WILL TAKE PRECEDENCE OVER ANY ELECTRONIC MEDIA.\*

DESIGN PROFESSIONAL  
MARCUS E. SACK

515 NORTH MAIN STREET  
P.O. BOX 649  
HINESVILLE, GA 31313  
TEL: (912) 368-5212



MUNICIPALITY:  
CITY OF FLEMINGTON

COUNTY:  
LIBERTY COUNTY

OWNER:  
CITY OF FLEMINGTON -  
MAYOR PAUL HAWKINS  
156 OLD SUNBURY ROAD  
FLEMINGTON, GA 31313  
PHONE: (912) 876-3223

JOB NO.: 2025-10 PRJ

CITY OF FLEMINGTON  
2025 LMIG  
INLET REPLACEMENT  
EXHIBIT

**C2**

PLOT DATE: February 3, 2026

TRANQUIL WAY (80' R/W)

APPROX. LIMIT OF GDOT R/W

REPLACE SWCB LID WITH  
GDOT STANDARD DROP  
INLET GRATE AND FRAME.  
SEE GDOT DETAIL 1019A.  
TOP TO BE TRAFFIC  
RATED 8" THICK (MIN.)

NF  
NORBERTO DUARTE  
& JANET SENTOVICH  
069D008

CONTRACTOR TO REPAIR/REPLACE ANY DAMAGED  
SIDEWALK AND MAINTAIN 4' MIN. WALKABLE PATH  
BETWEEN PROPOSED CURB AND BACK OF SIDEWALK

CONSTRUCT 4' WIDE CURB OFFSET  
4' FROM EXISTING FACE OF CURB

U.S. HWY. 84 EAST  
S.R. 196/38  
E. OGLETHORPE HWY  
(100' R/W)



DATE: 2/3/2026

SCALE BAR: 1"=10'



NF  
LAXMI MAA RENTAL LLC  
069D007

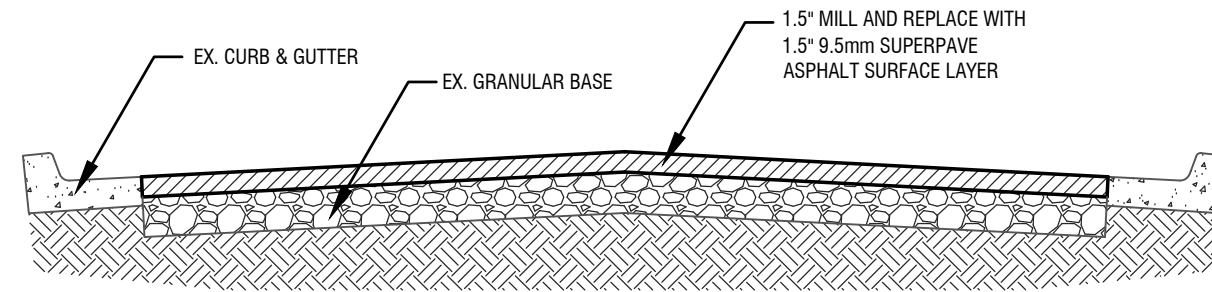

**ASPHALT PAVEMENT OVERLAY (CROWN W/C&G)**

N.T.S.

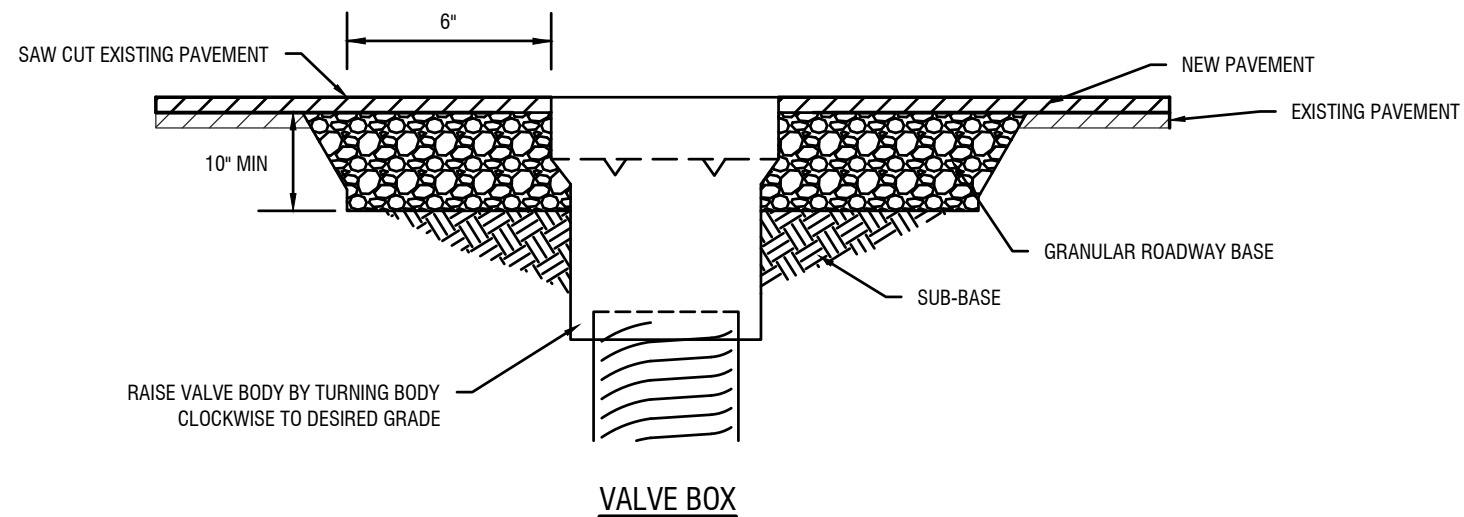

**VALVE BOX**

**NOTE:**

1. STRUCTURES SHALL NOT BE ADJUSTED FOR A PERIOD OF 24 HOURS AFTER RESURFACING IS COMPLETED IN THAT AREA
2. ASPHALT SHALL BE SAWCUT TO MAKE A SMOOTH, EVEN EDGE.
3. STRUCTURE SHALL BE ADJUSTED TO FIT FLUSH WITH STREET SURFACE.
4. USE AT LEAST 3/4" NON-SHRINK GROUT BETWEEN SPACERS AND MANHOLE FRAME.
5. CONTRACTOR SHALL TAKE ALL NECESSARY PRECAUTIONS TO ENSURE THAT MORTAR AND CONSTRUCTION MATERIAL DOES NOT DROP INTO MANHOLE OR SEWER LINES.
6. CONTRACTOR SHALL MAINTAIN TRAFFIC BARRIERS AND STEEL PLATES AROUND MANHOLE UNTIL CONCRETE CURES.
7. THE COMBINED HEIGHT OF STACKED GRADE RINGS SHALL BE A MAXIMUM OF 12 INCHES. ADJUSTMENTS EXCEEDING A HEIGHT OF 12 INCHES REQUIRE THE USE OF A MANHOLE RISER SECTION.

**STRUCTURE ADJUSTMENT IN TRAFFIC AREAS**

N.T.S.



DATE: 2/3/2026

DRAWING COMPLETED BY: CHRIS HEROLD

**REVISIONS:**

|  |
|--|
|  |
|  |
|  |
|  |
|  |
|  |

\*THIS DRAWING IS AN INSTRUMENT OF SERVICE AND REMAINS THE PROPERTY OF P.C. SIMONTON & ASSOCIATES, INC. AND M.E. SACK ENGINEERING. IT MAY NOT BE COPIED, ALTERED, OR REPRODUCED IN ANY MANNER WITHOUT PERMISSION ON A SIGNED AND SEALED DOCUMENT. THE INFORMATION CONTAINED HEREIN IS INTENDED FOR THE NAMED CLIENT ONLY. IN THE EVENT OF AN ELECTRONIC VERSION P.C. SIMONTON & ASSOC., INC. AND M.E. SACK ENGINEERING ASSUMES NO RESPONSIBILITY FOR DATA GENERATED, ALTERED OR STAKED FROM THIS DRAWING. IN THE EVENT OF A DISPUTE, HARD COPIES WILL TAKE PRECEDENCE OVER ANY ELECTRONIC MEDIA.\*

DESIGN PROFESSIONAL  
MARCUS E. SACK

515 NORTH MAIN STREET  
P.O. BOX 649  
HINESVILLE, GA 31313  
TEL: (912) 368-5212



MUNICIPALITY:  
CITY OF FLEMINGTON

COUNTY:  
LIBERTY COUNTY

OWNER:  
CITY OF FLEMINGTON -  
MAYOR PAUL HAWKINS  
156 OLD SUNBURY ROAD  
FLEMINGTON, GA 31313  
PHONE: (912) 876-3223

JOB NO.: 2025-10 PRJ

CITY OF FLEMINGTON  
2025 LMIG  
DETAILS

**C3**

PLOT DATE: February 3, 2026